

# iH<sup>2</sup>O INSULATED PIPE

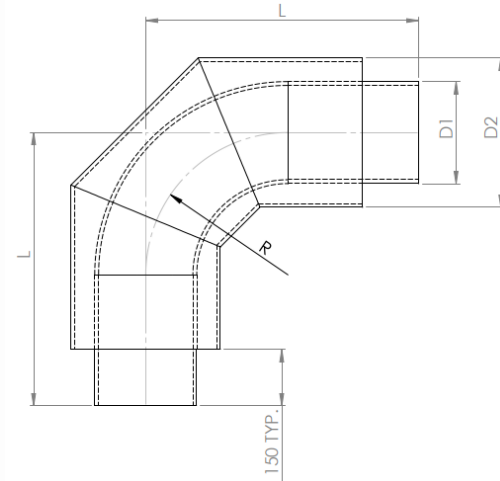

FOR SERVICE PIPE  
D1 ≤ 88.9mm (3 pieces)

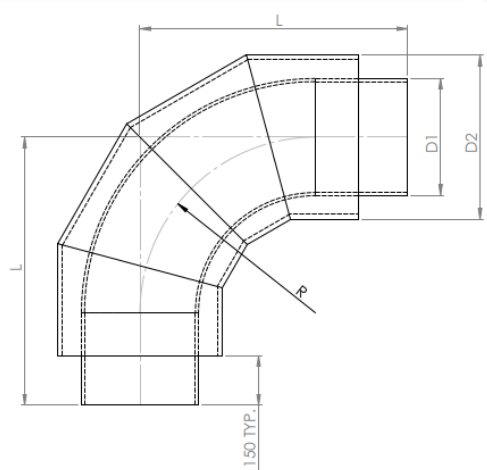

FOR SERVICE PIPE  
D1 > 88.9mm (4 pieces)

CS-HDPE PRE-INSULATED LONG RADIUS 90° BEND			
D1	D2	L	R
60.3	160	340	76
73	160	360	95
88.9	200	380	114
114.3	225	370	152
141.3	250	410	190
168.3	280	440	229
219.1	355	500	305
273.1	400	560	381
323.9	450	630	457
355.6	500	700	533
406.4	560	750	610
457	630	820	686
508	630	870	762

CS-HDPE PRE-INSULATED LONG RADIUS 45° BEND			
D1	D2	L	R
60.3	160	280	76
73	160	290	95
88.9	200	300	114
114.3	225	320	152
141.3	250	330	190
168.3	280	355	229
219.1	355	400	305
273.1	400	430	381
323.9	450	470	457
355.6	500	500	533
406.4	560	540	610
457	630	575	686
508	630	500	762

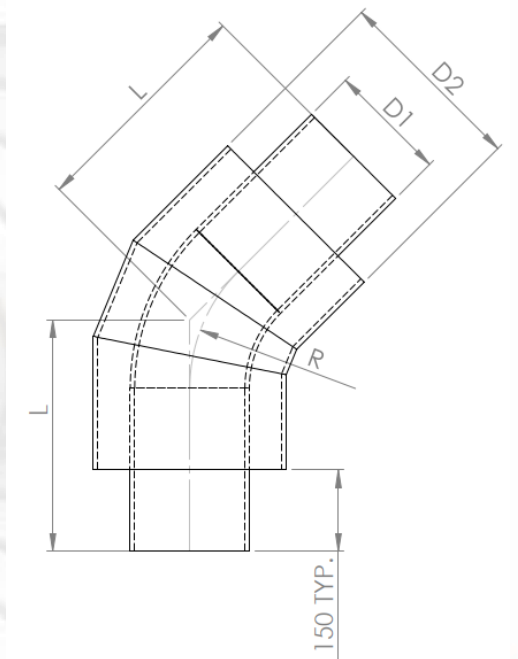

FOR SERVICE PIPE  
D1 ≤ 457mm (3 PIECES)

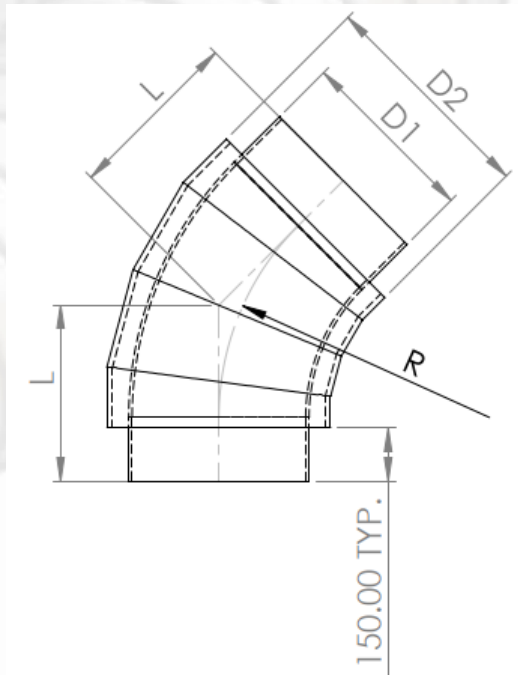

FOR SERVICE PIPE  
D1 > 457mm (4 PIECES)

